

Blackwoods

TRANSLAS 
DUTCH WELDING TECHNOLOGY

On-Gun Welding Fume Extraction

Translas available here!



CONTROL WELDING FUME AT THE SOURCE

On-gun fume extraction is too heavy, too bulky, and impacts the shielding gas...
Not anymore.

On-gun fume extraction is one of the safest and most effective methods of controlling welding fume and is heavily used and relied upon in Europe and North America. However, for the reasons above, on-gun extraction has not been adopted in Australia or New Zealand.

AWS has teamed up with Translas, Dutch on-gun fume extraction specialist, to launch an industry first: a range of lightweight, manoeuvrable, and ergonomic extraction guns that deliver the highest capture rate on the market (up to 98%), while leaving the shielding gas completely unaffected.

No other welding fume control solution captures welding fume at the source, removes it from the environment, and most importantly, follows the welder as they move. Experience Translas fume extraction technology today.

UP TO **98% CAPTURE RATE**
AND **100% DUTY CYCLE**

**REMOVES FUME AND
FOLLOWS THE WELDER**

UNLIKE OTHER FORMS OF LEV





Welding Fume Is Serious. Action Is Required.

The important point to understand is that while the risk posed by welding fume is serious, keeping yourself safe can be straightforward.

The 2017 IARC reclassification of welding fume as ‘carcinogenic to humans’ simply confirmed what was already known – welding fume is extremely bad for health and workplaces must protect their workers. Excessive exposure to welding fume can cause multiple types of cancer, including lung, larynx, and urinary tract.

‘Welders present, on average, a 43% increased risk of lung cancer when compared with those who have never welded or been exposed to welding fume’¹. ‘This increased risk of lung cancer is regardless of the type of steel welded, the welding process and independent of exposure to smoking’¹. Precedent for workers’ compensation based on a link between welding fume and cancer was established in the Australian courts back in 2014, opening the door for future compensation claims.

Aside from cancer, welding fume can also cause serious long-term health effects like lung function

Simple Takeaway

**Welding fume is serious,
action is required.**

abnormalities, including bronchial asthma, chronic obstructive pulmonary disease (COPD), pneumoconiosis and other pulmonary fibrosis, as well as stomach ulcers, kidney damage and nervous system damage.

Recognising welding fume as carcinogenic and the other associated health risks should encourage all employers of welders to review their risk assessments and revise their control measures.

Welding fume is serious, action is required.



TRANSLAS

DUTCH WELDING TECHNOLOGY



The safest and most effective method.



Extraction at the source is the safest and most effective solution to control welding fume in the work environment. Translas on-gun fume extraction captures harmful welding fumes and individual particulates as soon as they are generated, keeping the welder protected and the work environment fume free.

Up to 98% capture rate and 100% duty cycle.



Translas leads the industry with a fume capture rate up to 98%. However, like the eye of a storm, the cyclonic extraction effect leaves the shielding gas completely unaffected. The Translas range of fume guns are built tough and offer a 100% duty cycle.



Super lightweight & ergonomic fume gun.



On-gun fume extraction can no longer be considered too heavy and cumbersome, as Translas fume guns are the same weight or lighter than most standard welding guns. Moreover, the small ergonomic handle makes it one of the most comfortable guns to work with for any welder.

Low maintenance with self-cleaning.



The extraction system has an automatic cleaning function. The moment the pressure in the filter is too high, the units begin to automatically clean the filters. A variable frequency drive motor ensures extraction flow rates are always maintained at a precise level, making this powerful solution suitable for high production welding environments.

A potential option for confined spaces.



On-gun fume extraction captures welding fume before it can be released into the environment or build up around the welder, making Translas a potential option for confined spaces*. Due to the powerful variable frequency motor, the extraction unit can be positioned over 20 metres away from the welder and still deliver the same industry leading capture rate of up to 98%.

* Confined spaces can be deadly and decisions on how to handle a specific confined space must be assessed on the spot and always comes down to the specifics of the individual situation. There should be a suitably trained and knowledgeable person doing the assessment and design of a safe system for any confined space entry.

1. SELECT YOUR ON-GUN EXTRACTION PACKAGE



TRANSLAS 8XE 250 MINI MIG EXTRACTION SYSTEMS

Translas 250 On-Gun Fume Extraction System
ONE PERSON/ONE GUN

Part Number
0323 3047

TRANSLAS
DUTCH WELDING TECHNOLOGY

NEW

SELECT FOR WELDING BELOW 250 AMPS

AIR COOLED



LEARN MORE



- ✓ 250 amp air cooled on-gun fume extraction system
- ✓ Up to 98% capture rate leaves shielding gas unaffected
- ✓ Ergonomic and super lightweight welding gun
- ✓ Extraction system self cleans with auto start and stop
- ✓ 100% duty cycle with Euro connection
- ✓ Kit includes everything you need to get started with on-gun extraction

Translas 250 On-Gun Fume Extraction System
TWO PERSON/TWO GUN

Part Number
0323 3064

TRANSLAS
DUTCH WELDING TECHNOLOGY

NEW

SELECT FOR WELDING BELOW 250 AMPS

AIR COOLED



LEARN MORE



- ✓ Two person 250 amp air cooled on-gun fume extraction system
- ✓ Up to 98% capture rate leaves shielding gas unaffected
- ✓ Two ergonomic and super lightweight welding guns
- ✓ Extraction system self cleans with auto start and stop
- ✓ 100% duty cycle with Euro connection
- ✓ Kit includes everything you need to get started with on-gun extraction



TRANSLAS 8XE 400 MIG EXTRACTION SYSTEMS

Translas 400 On-Gun Fume Extraction System
ONE PERSON/ONE GUN

Part Number
0323 3081

TRANSLAS
DUTCH WELDING TECHNOLOGY

NEW

SELECT FOR WELDING 250 - 400 AMPS

 **AIR COOLED**



LEARN MORE



- ✓ 400 amp air cooled on-gun fume extraction system
- ✓ Up to 98% capture rate leaves shielding gas unaffected
- ✓ Ergonomic and super lightweight welding gun
- ✓ Extraction system self cleans with auto start and stop
- ✓ 100% duty cycle with Euro connection
- ✓ Kit includes everything you need to get started with on-gun extraction

Translas 400 On-Gun Fume Extraction System
TWO PERSON/TWO GUN

Part Number
0323 3098

TRANSLAS
DUTCH WELDING TECHNOLOGY

NEW

SELECT FOR WELDING 250 - 400 AMPS

 **AIR COOLED**



LEARN MORE



- ✓ Two person 400 amp air cooled on-gun fume extraction system
- ✓ Up to 98% capture rate leaves shielding gas unaffected
- ✓ Two ergonomic and super lightweight welding guns
- ✓ Extraction system self cleans with auto start and stop
- ✓ 100% duty cycle with Euro connection
- ✓ Kit includes everything you need to get started with on-gun extraction

1. SELECT YOUR ON-GUN EXTRACTION PACKAGE



TRANSLAS 8XE 500 MIG EXTRACTION SYSTEMS

Translas 500 On-Gun Fume Extraction System
ONE PERSON/ONE GUN

Part Number
0323 3115

TRANSLAS
DUTCH WELDING TECHNOLOGY

NEW

SELECT FOR WELDING OVER 400 AMPS



WATER COOLED



LEARN MORE



- ✓ 500 amp water cooled on-gun fume extraction system
- ✓ Up to 98% capture rate leaves shielding gas unaffected
- ✓ Ergonomic and super lightweight welding gun
- ✓ Extraction system self cleans with auto start and stop
- ✓ 100% duty cycle with Euro connection
- ✓ Kit includes everything you need to get started with on-gun extraction

Translas 500 On-Gun Fume Extraction System
TWO PERSON/TWO GUN

Part Number
0323 3132

TRANSLAS
DUTCH WELDING TECHNOLOGY

NEW

SELECT FOR WELDING OVER 400 AMPS



WATER COOLED



LEARN MORE



- ✓ Two person 500 amp water cooled on-gun fume extraction system
- ✓ Up to 98% capture rate leaves shielding gas unaffected
- ✓ Two ergonomic and super lightweight welding guns
- ✓ Extraction system self cleans with auto start and stop
- ✓ 100% duty cycle with Euro connection
- ✓ Kit includes everything you need to get started with on-gun extraction

2. SELECT YOUR CONSUMABLES

250 AMP GUN CONSUMABLE OPTIONS			
Item	Blackwoods Part Number	Description	Pack Quantity
A	0302 6701	Nozzle conical 12mm	5
	0302 6718	Nozzle conical 14mm tapered	5
B	0302 6820	Contact tip - CuCrZr tri metal nickel plated - for 0.9 wire	25
	0302 6837	Contact tip - CuCrZr tri metal nickel plated - for 1.0 wire	25
	0302 6854	Contact tip - CuCrZr tri metal nickel plated - for 1.2 wire	25
C	0302 6769	Tip adapter 250	10
D	0302 6922	Plastic coated liner red 4 metre - for 0.8 to 1.2 wire	1
	0302 6939	Plastic coated liner red 5 metre - for 0.8 to 1.2 wire	1
	0302 7024	Plastic coated liner yellow 4 metre - for 1.2 to 1.6 wire	1
	0302 7041	Plastic coated liner yellow 5 metre - for 1.2 to 1.6 wire	1

250 AMP GUN
A, B, C, & D are all required

- A. Select nozzle size
- B. Select contact tip based on wire size
- C. Tip adapter required
- D. Select a liner based on wire size

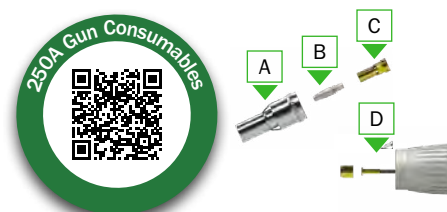

400 AMP GUN CONSUMABLE OPTIONS			
Item	Blackwoods Part Number	Description	Pack Quantity
A	0302 6735	Nozzle conical 14mm tapered	5
	0302 6752	Nozzle conical 17mm tapered	5
B	0302 6820	Contact tip - CuCrZr tri metal nickel plated - for 0.9 wire	25
	0302 6837	Contact tip - CuCrZr tri metal nickel plated - for 1.0 wire	25
	0302 6854	Contact tip - CuCrZr tri metal nickel plated - for 1.2 wire	25
	0302 6871	Contact tip - CuCrZr tri metal nickel plated - for 1.6 wire	25
	0302 6871	Contact tip - CuCrZr tri metal nickel plated - for 1.6 wire	25
C	0302 7296	Tip adapter 400	10
D	0302 6956	Plastic coated liner black 4 metre - for 0.9 to 1.2 wire	1
	0302 6973	Plastic coated liner black 5 metre - for 0.9 to 1.2 wire	1
	0302 6990	Plastic coated liner grey 4 metre - for 1.6 wire	1
	0302 7007	Plastic coated liner grey 5 metre - for 1.6 wire	1

400 AMP GUN
A, B, C, & D are all required

- A. Select nozzle size
- B. Select contact tip based on wire size
- C. Tip adapter required
- D. Select a liner based on wire size

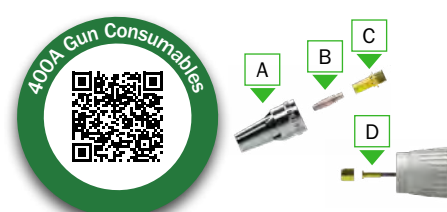

500 AMP GUN CONSUMABLE OPTIONS			
Item	Blackwoods Part Number	Description	Pack Quantity
A	0302 6735	Nozzle conical 14mm tapered	5
	0302 6752	Nozzle conical 17mm tapered	5
B	0302 6820	Contact tip - CuCrZr tri metal nickel plated - for 0.9 wire	25
	0302 6837	Contact tip - CuCrZr tri metal nickel plated - for 1.0 wire	25
	0302 6854	Contact tip - CuCrZr tri metal nickel plated - for 1.2 wire	25
	0302 6871	Contact tip - CuCrZr tri metal nickel plated - for 1.6 wire	25
	0302 6871	Contact tip - CuCrZr tri metal nickel plated - for 1.6 wire	25
C	0302 6786	Tip adapter 500	10
D	0302 6922	Plastic coated liner red 4 metre - for 0.8 to 1.2 wire	1
	0302 6939	Plastic coated liner red 5 metre - for 0.8 to 1.2 wire	1
	0302 7024	Plastic coated liner yellow 4 metre - for 1.2 to 1.6 wire	1
	0302 7041	Plastic coated liner yellow 5 metre - for 1.2 to 1.6 wire	1

500 AMP GUN
A, B, C, & D are all required

- A. Select nozzle size
- B. Select contact tip based on wire size
- C. Tip adapter required
- D. Select a liner based on wire size



TECHNICAL SPECIFICATIONS



Specification	Translas 8XE 250 Amp On-Gun Fume Extraction System	Translas 8XE 250 Amp On-Gun Fume Extraction Double System	Translas 8XE 400 Amp On-Gun Fume Extraction System
Blackwoods Part Number	0323 3047	0323 3064	0323 3081
Number of Users	1	2	1
Recommended Amps	250 Amps and below	250 Amps and below	250 - 400 Amps
Air/Water Cooled	Air Cooled	Air Cooled	Air Cooled
CO²	280 Amp	280 Amp	420 Amp
Mixed Gases	250 Amp	250 Amp	400 Amp
Duty Cycle	100%	100%	100%
Fume Capture Rate	Up to 98%	Up to 98%	Up to 98%
Gun Rotation	360° Swivel	360° Swivel	360° Swivel
Automatic Start/Stop	Yes	Yes	Yes
Auto Filter Cleaning	Yes	Yes	Yes
Dimensions	(L x B x H) 700 x 440 x 585 / 630mm (without / with wheels)	(L x W x H) 700 x 530 x 560 / 630mm (without / with wheels)	(L x B x H) 700 x 440 x 585 / 630mm (without / with wheels)
Implementation	Mobile on 4 wheels - 2 rotating with locks	Mobile on 4 wheels - 2 rotating with locks	Mobile on 4 wheels - 2 rotating with locks
Power Supply	380-480V (3 Phase)	380-480V (3 Phase)	380-480V (3 Phase)
Motor Power	1.5 KW	Maximum 3.0 KW	1.5 KW
Suction Flow (Torch)	Target: 33 CFM / Max: 38 CFM	Target: 33 CFM / Max: 38 CFM	Target: 33 CFM / Max: 38 CFM
Filter Surface	5m ² Active filter surface, filter efficiency: IFA >99.8%	5m ² Active filter surface, filter efficiency: IFA >99.8%	5m ² Active filter surface, filter efficiency: IFA >99.8%
Working Temperature	0 to +50°C	0 to +50°C	0 to +50°C
Weight	45kg	58kg	45kg
Noise Level	Max. dB(A) <65dB(A) (at 100% suction flow)	Max. dB(A) <65dB(A) (at 100% suction flow)	Max. dB(A) <65dB(A) (at 100% suction flow)
Certifications	CE (European), W3 (Germany), and CSA (North America)	CE (European), W3 (Germany), and CSA (North America)	CE (European), W3 (Germany), and CSA (North America)
Compressed Air (Cleaning)	80 PSI (5.5 Bar), Dry/Clean Air, 20 CFM, Standard Size Airline	80 PSI (5.5 Bar), Dry/Clean Air, 20 CFM, Standard Size Airline	80 PSI (5.5 Bar), Dry/Clean Air, 20 CFM, Standard Size Airline

Kits include everything you need to get started with on-gun fume extraction: fume gun(s), extraction unit, hose(s), sensing cable(s), compressed air valve, airflow metre, filters, consumables (tip, tip adapter, nozzle, liner).



Translas 8XE 400 Amp On-Gun Fume Extraction Double System	Translas 8XE 500 Amp On-Gun Fume Extraction System	Translas 8XE 500 Amp On-Gun Fume Extraction Double System
0323 3098	0323 3115	0323 3132
2	1	2
250 - 400 Amps	Over 400 Amps	Over 400 Amps
Air Cooled	Water Cooled	Water Cooled
420 Amp	550 Amp	550 Amp
400 Amp	500 Amp	500 Amp
100%	100%	100%
Up to 98%	Up to 98%	Up to 98%
360° Swivel	360° Swivel	360° Swivel
Yes	Yes	Yes
Yes	Yes	Yes
(L x W x H) 700 x 530 x 560 / 630mm (without / with wheels)	(L x B x H) 700 x 440 x 585 / 630mm (without / with wheels)	(L x W x H) 700 x 530 x 560 / 630mm (without / with wheels)
Mobile on 4 wheels - 2 rotating with locks	Mobile on 4 wheels - 2 rotating with locks	Mobile on 4 wheels - 2 rotating with locks
380-480V (3 Phase)	380-480V (3 Phase)	380-480V (3 Phase)
Maximum 3.0 KW	1.5 KW	Maximum 3.0 KW
Target: 33 CFM / Max: 38 CFM	Target: 33 CFM / Max: 38 CFM	Target: 33 CFM / Max: 38 CFM
5m ² Active filter surface, filter efficiency: IFA >99.8%	5m ² Active filter surface, filter efficiency: IFA >99.8%	5m ² Active filter surface, filter efficiency: IFA >99.8%
0 to +50°C	0 to +50°C	0 to +50°C
58kg	45kg	58kg
Max. dB(A) <65dB(A) (at 100% suction flow)	Max. dB(A) <65dB(A) (at 100% suction flow)	Max. dB(A) <65dB(A) (at 100% suction flow)
CE (European), W3 (Germany), and CSA (North America)	CE (European), W3 (Germany), and CSA (North America)	CE (European), W3 (Germany), and CSA (North America)
80 PSI (5.5 Bar), Dry/Clean Air, 20 CFM, Standard Size Airline	80 PSI (5.5 Bar), Dry/Clean Air, 20 CFM, Standard Size Airline	80 PSI (5.5 Bar), Dry/Clean Air, 20 CFM, Standard Size Airline

ON-GUN FUME EXTRACTION



 AIR COOLED

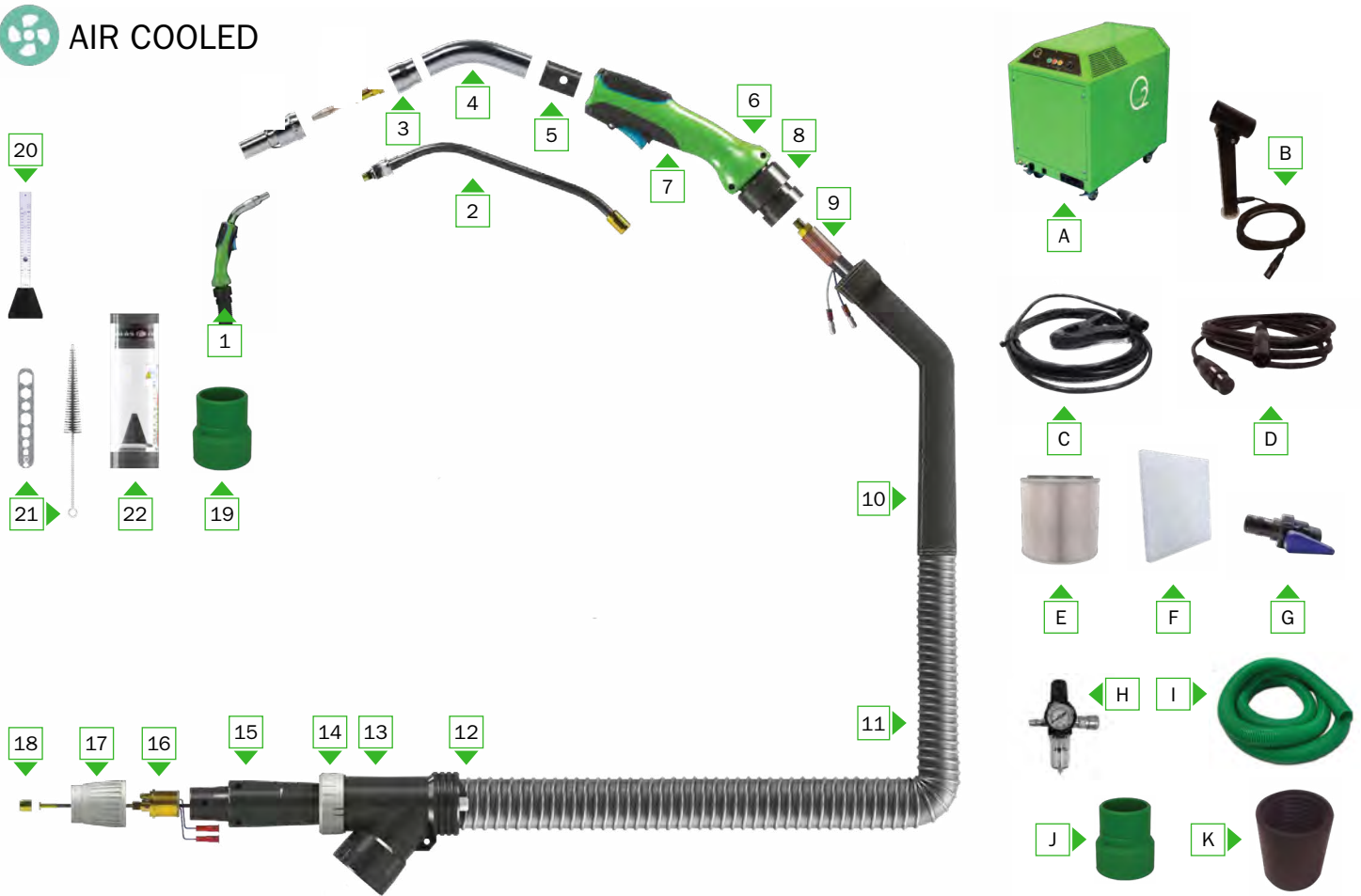

Spare Parts - GUN

Item	Part Number	Description	Item	Part Number	Description
1	0302 6599	8XE MINI extractor Eur 250 amp 4 metre 45°	10	0323 3727	Leather-sheathing with velcro 2mtr
	0302 6616	8XE MINI extractor Eur 250 amp 5 metre 45°	11	0323 3659	Fume extraction hose 30-38mm 4mtr
2	0323 3251	Swan neck 45°		0323 3676	Fume extraction hose 30-38mm 5mtr
	0323 3438	PEEK ring to fix nozzle holder (not shown)	12	0323 3829	Hose connection
3	0323 3404	Nozzle holder	13	0323 3812	Housing (Y-shape) for fume extraction hose
4	0323 3353	Metal neck 45°	14	0323 3863	Connection ring
5	0323 3387	Adapter to fit MINI neck	15	0323 3557	Housing set for central connector
6	0323 3795	Handle green/black complete with trigger	16	0323 3302	Central connector
7	0323 3472	Trigger	17	0323 3574	Adaptor nut
	0323 3489	Spring for trigger (not shown)	18	0431 0915	Liner positioner nut
	0323 3506	Micro switch complete (not shown)	19	0302 7194	Hose adapter
8	0323 3523	Cable support set with ball-and-socket joint	20	0323 3608	Gasflow metre
9	0323 3149	Cable assembly 4mtr	21	0323 3625	Tool set (brush and multitool)
	0323 3166	Cable assembly 5mtr	22	0302 7262	Airflow metre MINI Extractor

Spare Parts - EXTRACTION UNIT

Item	Part Number	Description	Item	Part Number	Description
A	0302 7058	W150 ClearO2 mobile fume unit 3 phase	F	0302 7313	Filter Mat pk=5
	0302 7075	W200 ClearO2 mobile fume unit 2 welders 3 phase	G	0302 7245	Ball valve to reduce the suction flow
B	0302 7092	Torch holder for automatic start/stop 5 metre 250	H	0302 7228	Compressed air regulator with moisture trap
C	0302 7126	Sensing cable auto start/stop 4 metre	I	0302 7177	ClearO2 suction hose 5mtr
D	0302 7143	Extension 5 metre for sensor cable clamp	J	0302 7194	Hose adapter
E	0302 7160	Main Filter	K	0302 7330	Coupler to extend the suction hose

 AIR COOLED

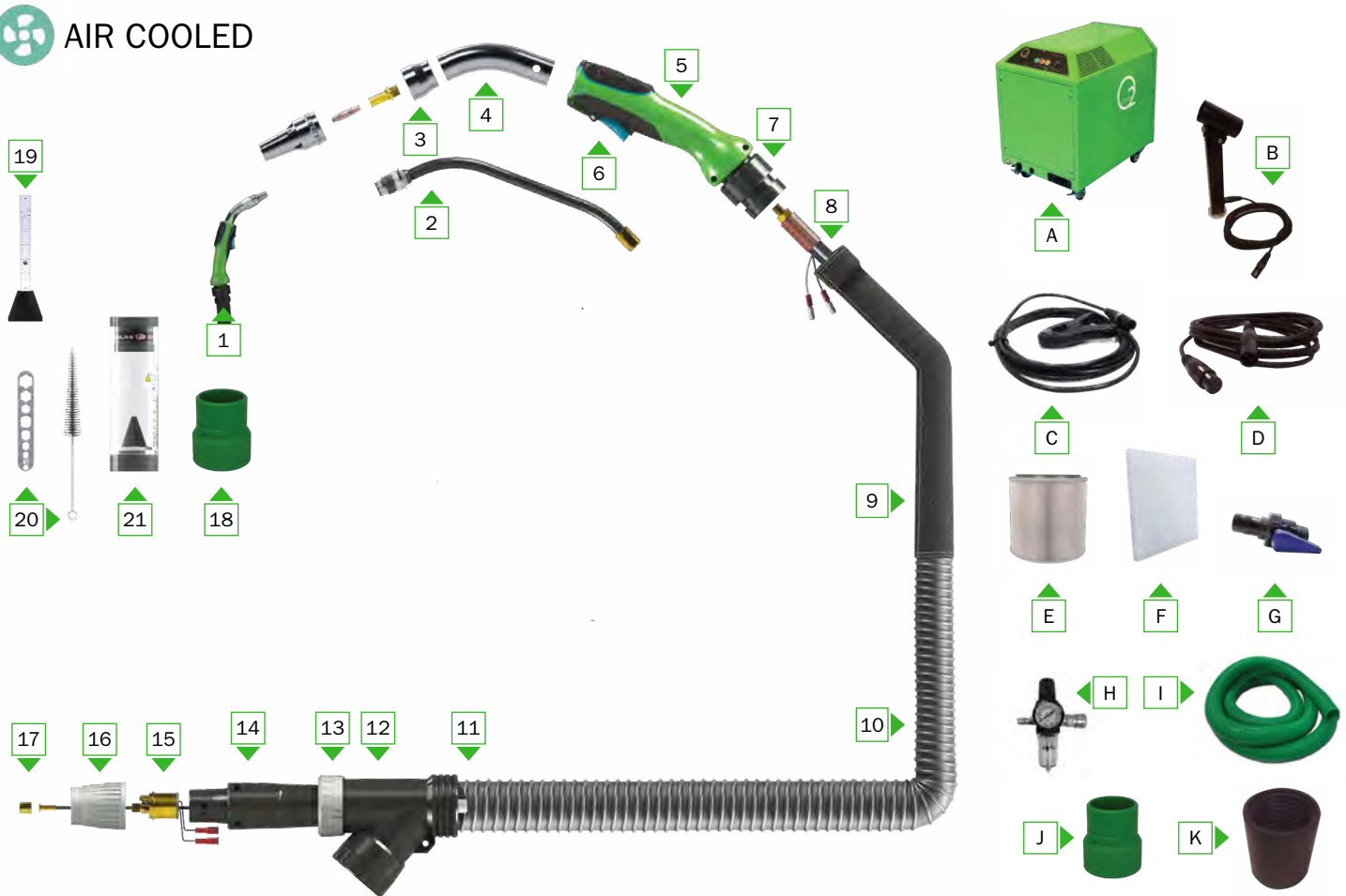

Spare Parts - GUN					
Item	Part Number	Description	Item	Part Number	Description
1	0302 6633	8XE extractor Eur 400 amp 4 metre 45°	10	0323 3693	Fume extraction hose 36-44mm 4mtr
	0302 6650	8XE extractor Eur 400 amp 5 metre 45°		0323 3710	Fume extraction hose 36-44mm 5mtr
2	0323 3268	Swan neck 45°	11	0323 3846	Hose connection
	0323 3455	PEEK ring to fix nozzle holder (not shown)	12	0323 3812	Housing (Y-shape) for fume extraction hose
3	0323 3421	Nozzle holder	13	0323 3863	Connection ring
4	0323 3370	Metal neck 45°	14	0323 3557	Housing set for central connector
5	0323 3795	Handle green/black complete with trigger	15	0323 3319	Central connector
6	0323 3472	Trigger	16	0323 3574	Adaptor nut
	0323 3489	Spring for trigger (not shown)	17	0431 0915	Liner positioner nut
	0323 3506	Micro switch complete (not shown)	18	0302 7194	Hose adapter
7	0323 3540	Cable support set with ball-and-socket joint	19	0323 3608	Gasflow metre
8	0323 3183	Cable assembly 4mtr	20	0323 3625	Tool set (brush and multitool)
	0323 3200	Cable assembly 5mtr	21	0302 7279	Airflow metre Extractor
9	0323 3744	Leather-sheathing with velcro 2mtr			
Spare Parts - EXTRACTION UNIT					
Item	Part Number	Description	Item	Part Number	Description
A	0302 7058	W150 ClearO2 mobile fume unit 3 phase	F	0302 7313	Filter Mat pk=5
	0302 7075	W200 ClearO2 mobile fume unit 2 welders 3 phase	G	0302 7245	Ball valve to reduce the suction flow
B	0302 7109	Torch holder for automatic start/stop 5 metre 400	H	0302 7228	Compressed air regulator with moisture trap
C	0302 7126	Sensing cable auto start/stop 4 metre	I	0302 7177	ClearO2 suction hose 5mtr
D	0302 7143	Extension 5 metre for sensor cable clamp	J	0302 7194	Hose adapter
E	0302 7160	Main Filter	K	0302 7330	Coupler to extend the suction hose

 WATER COOLED

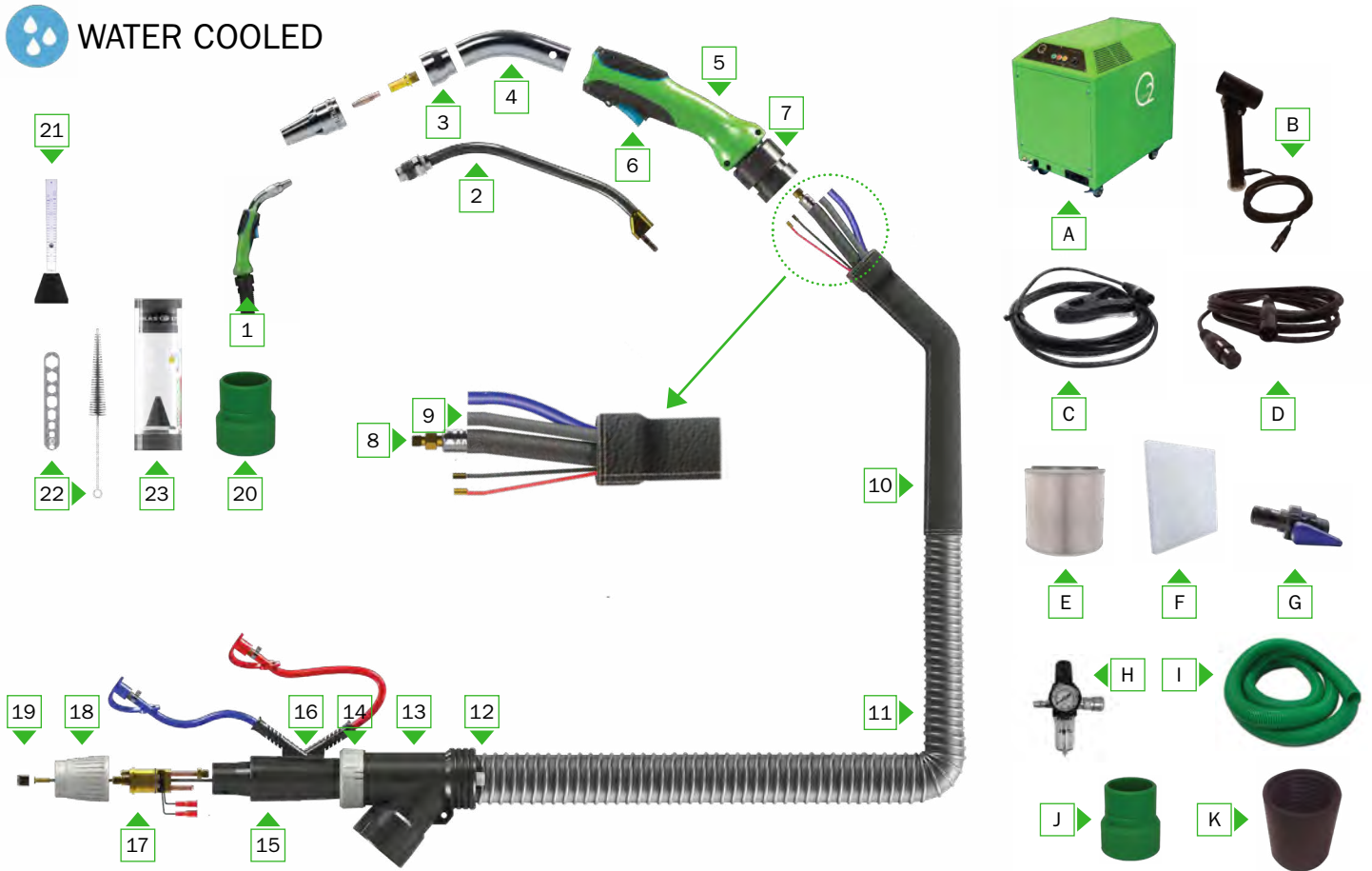

Spare Parts - GUN

Item	Part Number	Description	Item	Part Number	Description
1	0302 6667	8XE extractor Eur 500 amp 4 metre 45°	10	0323 3744	Leather-sheathing with velcro 2mtr
	0302 6684	8XE extractor Eur 500 amp 5 metre 45°	11	0323 3693	Fume extraction hose 36-44mm 4mtr
2	0323 3285	Swan neck 45°		0323 3710	Fume extraction hose 36-44mm 5mtr
	0323 3455	PEEK ring to fix nozzle holder (not shown)	12	0323 3846	Hose connection
3	0323 3421	Nozzle holder	13	0323 3812	Housing (Y-shape) for fume extraction hose
4	0323 3370	Metal neck 45°	14	0323 3863	Connection ring
5	0323 3795	Handle green/black complete with trigger	15	0323 3557	Housing set for central connector
	0323 3472	Trigger	16	0323 3591	Water hose guide
	0323 3489	Spring for trigger (not shown)	17	0323 3336	Central connector
	0323 3506	Micro switch complete (not shown)	18	0323 3574	Adapter nut
7	0323 3540	Cable support set with ball-and-socket joint	19	0431 0915	Liner positioner nut
8	0323 3217	Power/water cable 4mtr	20	0302 7194	Hose adapter
	0323 3234	Power/water cable 5mtr	21	0323 3608	Gasflow metre
9	0323 3761	Outer liner 4mtr	22	0323 3625	Tool set (brush and multitool)
	0323 3778	Outer liner 5mtr	23	0302 7279	Airflow metre extractor

Spare Parts - EXTRACTION UNIT

Item	Part Number	Description	Item	Part Number	Description
A	0302 7058	W150 ClearO2 mobile fume unit 3 phase	F	0302 7313	Filter Mat pk=5
	0302 7075	W200 ClearO2 mobile fume unit 2 welders 3 phase	G	0302 7245	Ball valve to reduce the suction flow
B	0302 7109	Torch holder for automatic start/stop 5 metre 500	H	0302 7228	Compressed air regulator with moisture trap
C	0302 7126	Sensing cable auto start/stop 4 metre	I	0302 7177	ClearO2 suction hose 5mtr
D	0302 7143	Extension 5 metre for sensor cable clamp	J	0302 7194	Hose adapter
E	0302 7160	Main Filter	K	0302 7330	Coupler to extend the suction hose

AIR QUALITY IN YOUR WORKSHOP

When you consider a welding fume particle that is 0.5 µm in size can take 2 days to reach the floor when released from a height of 1.5 metres, you begin to understand how long these carcinogenic particles can remain suspended in the air. This is vital to consider when sharing a work environment with welders, as the air could contain respiratory hazards long after welding has been completed.

On-gun fume extraction can assist in reducing exposure to welding fume and other airborne contaminants, not only for the welder, but also for those who work near welding operations. This is the key difference between on-gun fume extraction and Personal Protective Equipment (PPE) used by the welder. PPE can only protect the welder, while on-gun fume extraction can protect the welder and stop the spread of fume throughout the workplace protecting all workers from welding fume exposure.

For this reason, on-gun fume extraction can be the most economical method to protect all workers from welding fume exposure in shared working environments.



UP TO 98% CAPTURE RATE & 100% DUTY CYCLE

**REMOVES FUME AND FOLLOWS THE WELDER
UNLIKE OTHER FORMS OF LEV**



OUR TEAM OF WELDING, GAS & ABRASIVES TECHNICAL SPECIALISTS



PETER AGNOS
HEAD OF TECHNICAL

25YRS
INDUSTRIAL
EXPERIENCE



+61 417 819 584



Peter.Agnos@blackwoods.com.au

PAUL CARTMELL
TECH SPECIALIST TEAM LEADER -
WELDING, GAS & ABRASIVES -
METRO / NTH WA



+61 428 865 249



Paul.Cartmell@blackwoods.com.au

20YRS
WELDING, GAS
& ABRASIVES
EXPERIENCE



+61 484 756 949



Brooke.Aubrey@blackwoods.com.au

40YRS
WELDING, GAS
& ABRASIVES
EXPERIENCE

JAMIE NATOLI
TECH SPECIALIST TEAM LEADER
- WELDING, GAS & ABRASIVES
- NSW

13YRS
WELDING, GAS
& ABRASIVES
EXPERIENCE



+61 492 003 126



Jamie.Natoli@blackwoods.com.au

GEOFF CHARLTON
TECH SPECIALIST - WELDING, GAS
& ABRASIVES - METRO / STH WA



+61 438 048 392



Geoff.Charlton@blackwoods.com.au

20YRS
WELDING, GAS
& ABRASIVES
EXPERIENCE

CONTACT OUR
WELDING SPECIALIST TEAM AT
WELDING@BLACKWOODS.COM.AU
FOR ANY TECHNICAL SUPPORT
AND ENQUIRIES ON
THESE OFFERS

